

For RFCS-14E And RFCS-6L Foot Controls

WARNING

READ SAFETY BLOCKS in welding power source Owner's Manual before proceeding.

1. Typical Connection

See welding power source Owner's Manual to determine if Remote Foot Control works as a combination or as full Amperage control.

Turn Off welding power source.

- 1 Foot Control
- 2 Remote 14 Or Remote 6 Receptacle

Insert plug into matching 14-socket, or 6-socket receptacle, as applicable, on welding power source. Tighten collar.

Set the power source Remote/Panel toggle switch(es) to the Remote Position.

Press pedal lightly to turn weld output and gas flow on. Press pedal further to increase weld output. Release pedal to turn off weld output and gas flow.

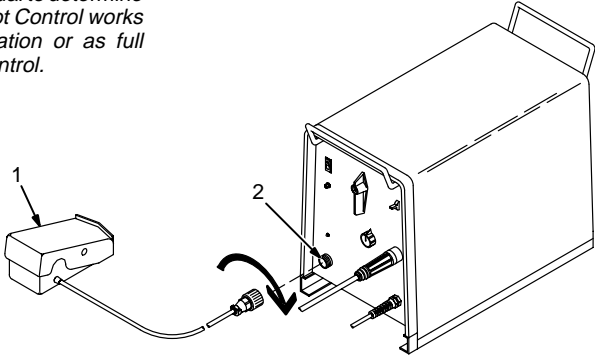

Ref. ST-801 736

2. Circuit Diagrams

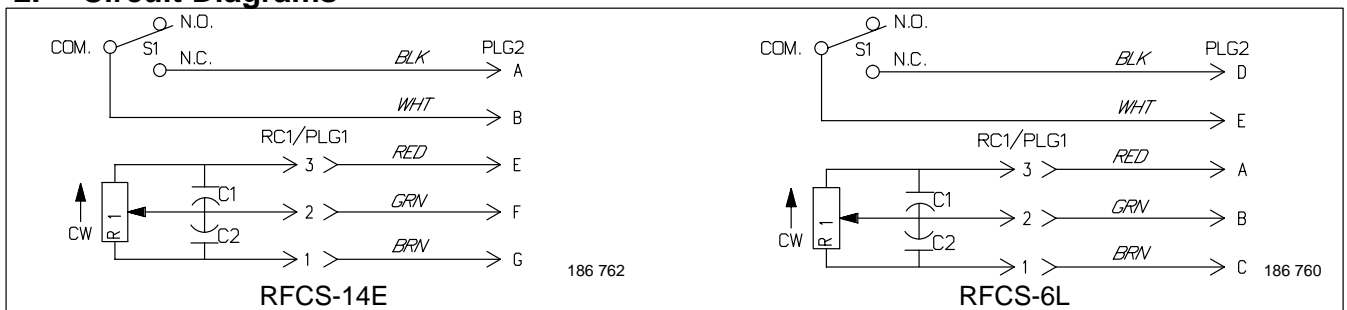

3. Parts List

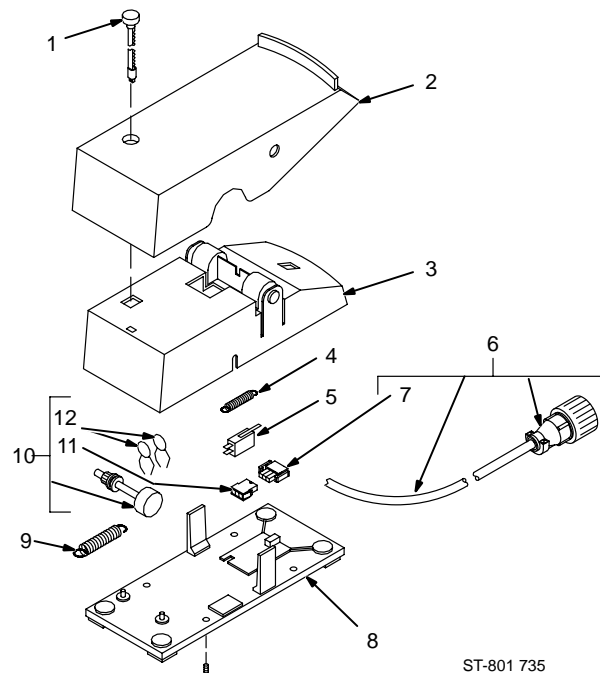

Item No.	Dia. Mkgs.	Part No.	Description	Qty	
				14E	6L
1		182 030	Belt, drive	1	1
2		182 029	Pedal, foot	1	1
3		182 027	Housing, foot control	1	1
4		182 627	Spring, ext .375 OD	1	1
5	S1	183 629	Switch, limit 10A 125/250V	1	1
6	PLG2	186 777	Cable Control	1	
6		186 749	Cable Control		1
7	PLG1	131 204	Connector & Sockets	1	1
		186 750	Connector & Pins		1
		138 033	Connector, clamp		1
8		182 028	Plate, bottom	1	1
9		182 626	Spring, ext .750 OD	1	1
10	R1	186 751	Potentiometer w/Leads 10k ohm	1	1
11	RC1	131 203	Connector & Sockets	1	1
12	C1,2	028 291	Capacitor, cer disc	2	2

BE SURE TO PROVIDE MODEL AND STYLE NUMBER WHEN ORDERING REPLACEMENT PARTS.

4. Adjusting Potentiometer Timing

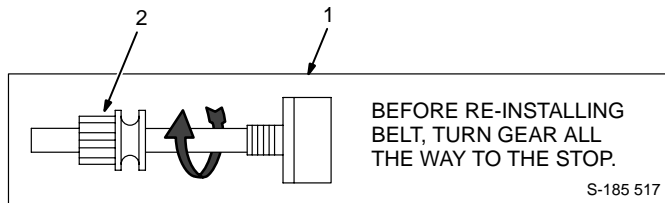

Disconnect foot control from welding power source/generator.

Turn unit upside down, and remove bottom plate.

1 Label

2 Gear

Turn gear on potentiometer shaft counterclockwise as far as possible.

Pull drive belt tight and mesh belt teeth with gear teeth.

Connect free end of small spring into end of drive belt.

Reinstall bottom plate