

This print is and will remain the property of Miller Electric Mfg Co. Appleton, WI. Furnished with the understanding it is not to be duplicated in any manner without approval of Miller Electric Mfg Co. This print is furnished to assist order requirements and will be returned to Miller Electric Mfg Co upon request.

MATERIAL: .250 THK CR STEEL ASTM A1008 CS TYPE B
FINISH: PAINT POWDER BLACK PER MILLER PAINT STANDARD 179295

NOTE: REMOVE ALL BURRS AND SHARP EDGES

HOLE LEGEND

- A - 0.257 DIA. THRU
- B - 0.404 DIA. THRU W/C'SINK 82° X 0.633 DIA.
- C - 0.246 DIA. THRU W/C'SINK 82° X 0.484 DIA.
- D - 1/4-20 UNC-2B THRU
- E - 0.281 DIA. THRU

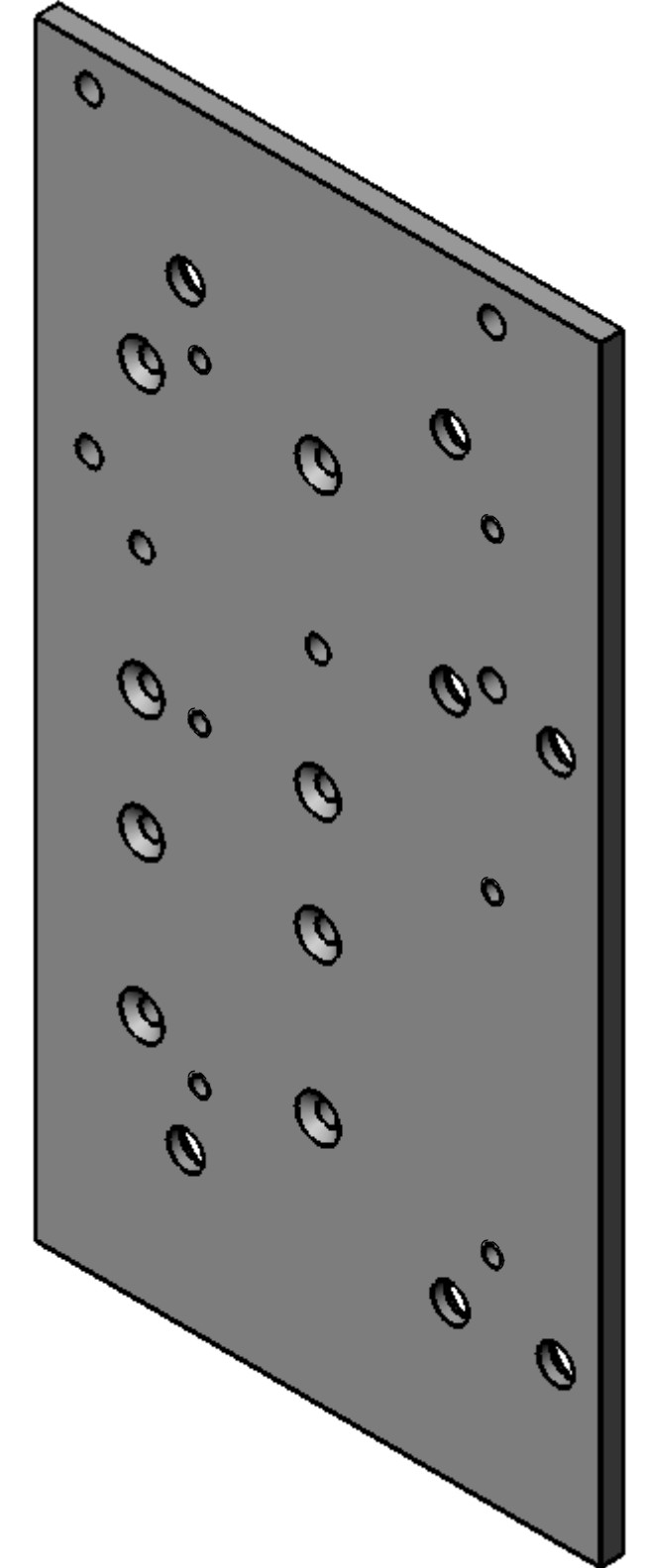
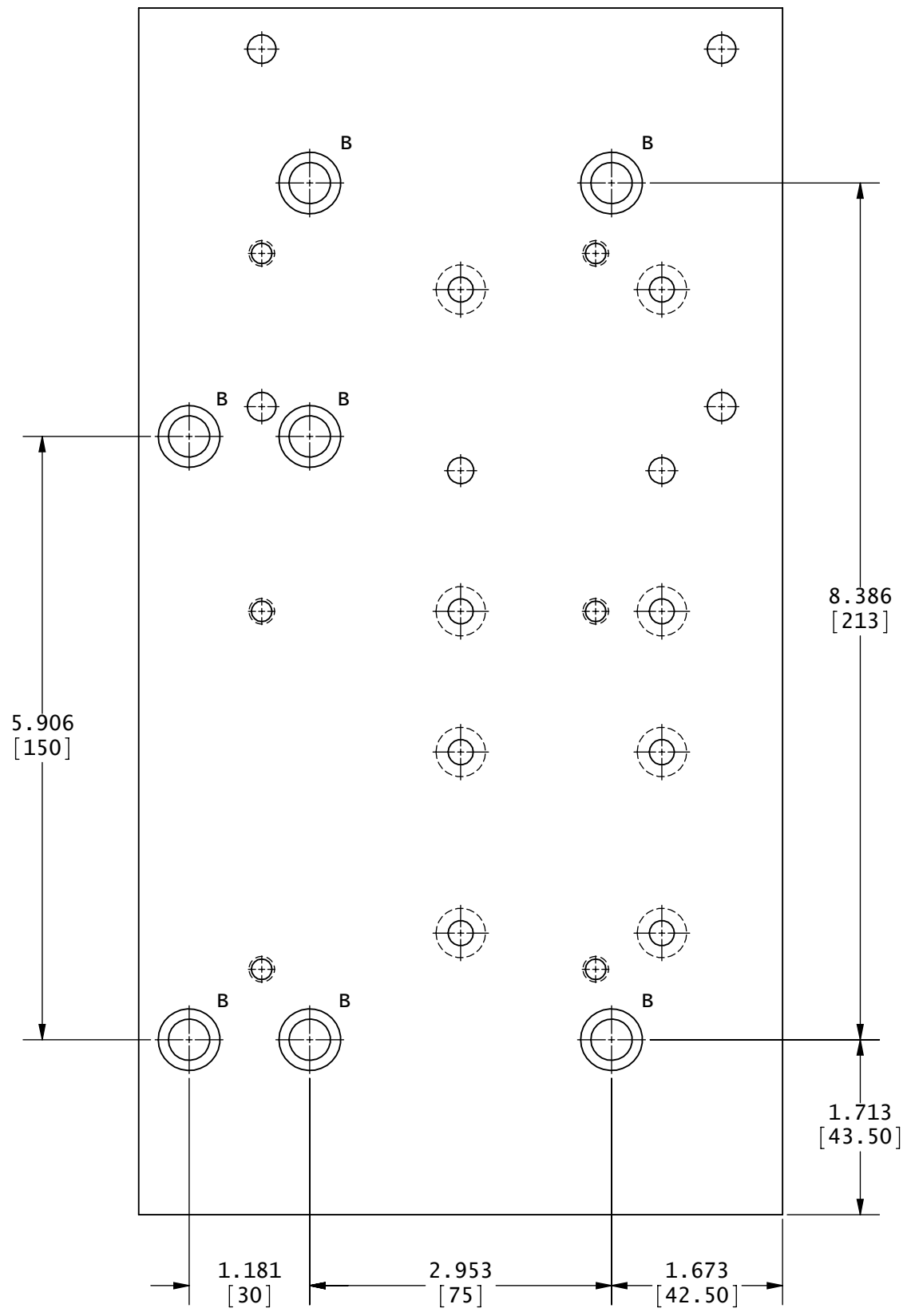
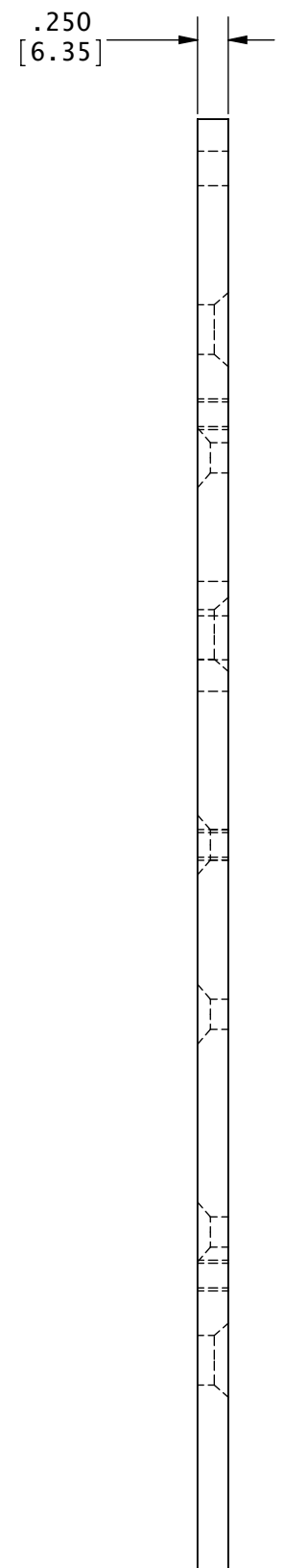
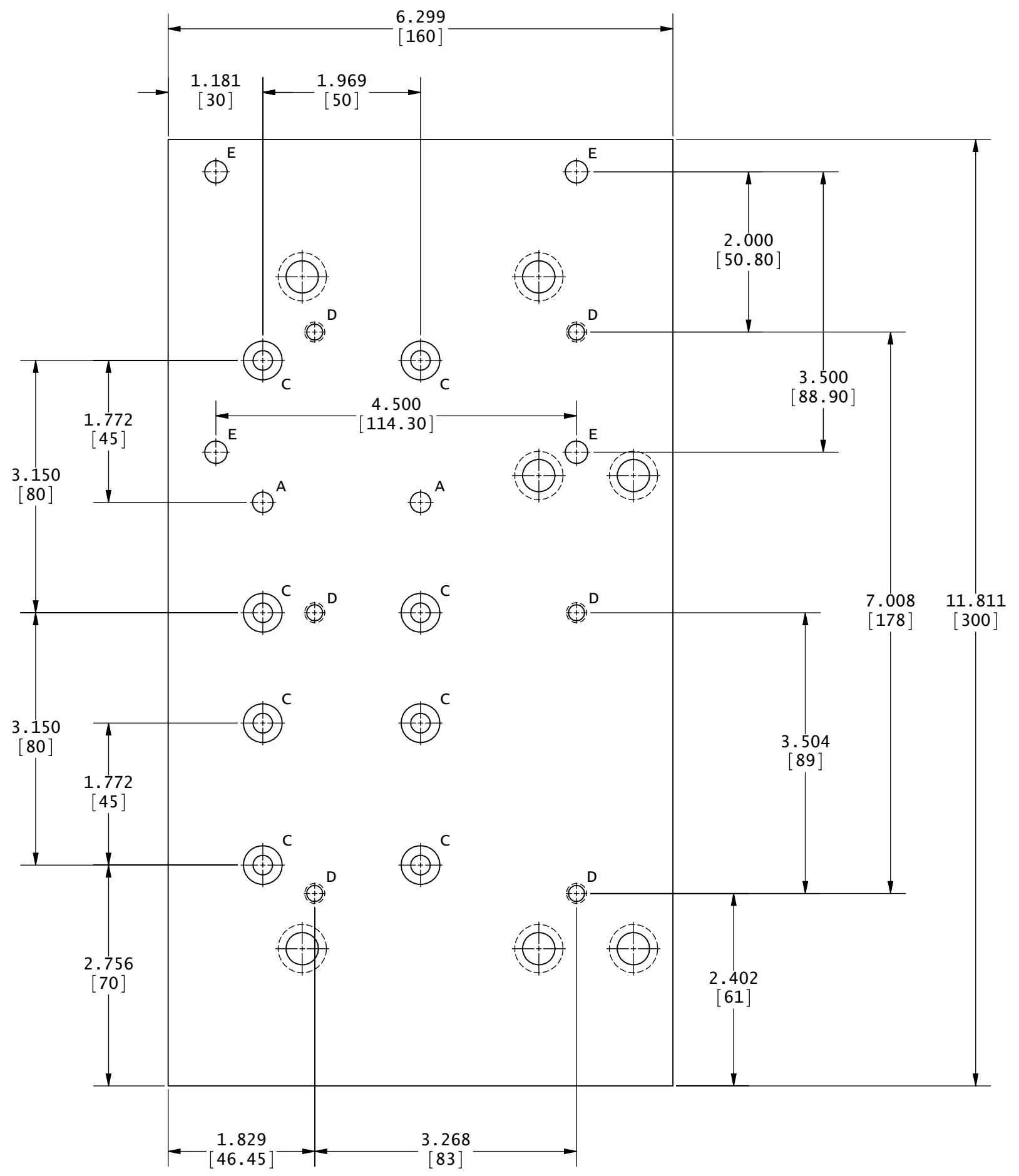

ROHS COMPLIANT

Rev	Date	By	ECO	Revision Description	Tolerances Unless Otherwise Specified	MILLER ELECTRIC MFG. CO., APPLETON, WI. USA			
E	10-10-14	PEK BAS	023325	ADDED (3) 'B' HOLES @ THE 1.181[20] AND 5.906[150] DIMENSIONS	Decimal ±: .015	Title: BRACKET, MTG MOTOMAN/FANUC WIRE DRIVE ROBOT			
D	03-25-13	PEK DWS	019473	ADDED SET OF 'D' HOLES AT THE 4.500[114.30] DIMENSION AND A SET OF 'E' HOLES	Fractional ±:				
C	12-21-05	DWS KS	326	MOVE 'D' HOLES 5/16 TO THE RIGHT AND CHANGE FROM .247 TO .201 FOR TAPPING 1/4-20	Angular ±: 1°	DRAWING NOT TO SCALE		CONFIDENTIAL	
B	05-10-05	JD DWS		INITIAL RELEASE	Finish:	Drawn By: JD	Size: C	Drawing No: 224302	Rev: E
1		JD DWS		PROTOTYPE		Date: 05-10-05			
Rev	Date	By	ECO	Revision Description					